



Wentworth Terrace, Rawdon, Leeds, LS19

Rent £845 Deposit £975

ManningStainton

helping people move



GROUND FLOOR APPROX. 25 SQ. METERS (267 SQ FEET) **FIRST FLOOR** APPROX. 24 SQ. METERS (260 SQ FEET)

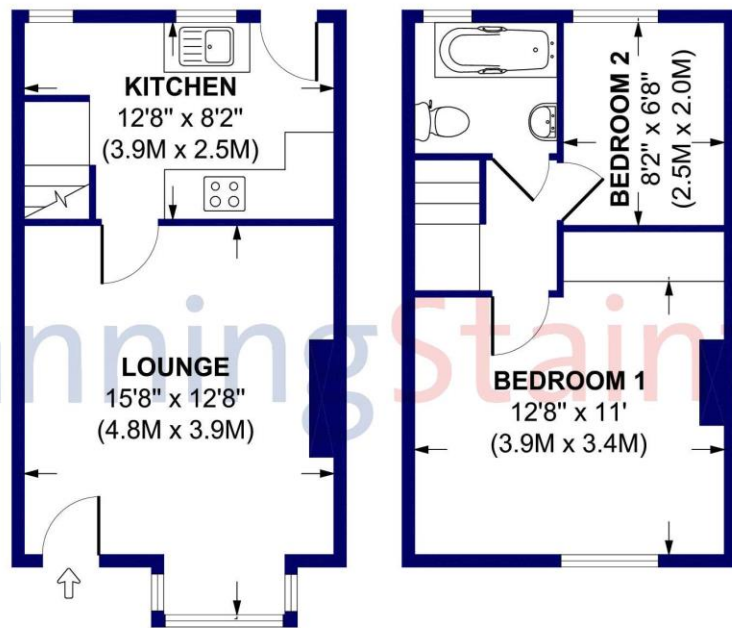

WENTWORTH TERRACE

APPROX. GROSS INTERNAL FLOOR AREA 528 SQ FT / 49 SQ M

ILLUSTRATION FOR IDENTIFICATION PURPOSES ONLY - NOT TO SCALE

© Manning Stainton

Viewing:

By appointment only through our North Leeds Lettings branch available Monday – Friday 9.00 – 17.30 (apart from Wednesday 09.45 – 17.30) and Saturday 09:00 to 12:00.

Application Procedure:

The property is offered subject to a formal tenancy agreement and satisfactory references. All tenants are required to pay rent in advance and a dilapidations deposit.

Holding Deposit:

If your application is provisionally accepted, we will take a holding deposit to reserve a property whilst reference checks and preparation for a tenancy agreement are performed. A further letter of explanation confirming the terms and conditions regarding this payment and your legal rights will be provided to you before your money is taken.

Pets:

Any pets agreed will be at the discretion of the Landlord. Should it be agreed, the charge will be added to the monthly rent and detailed within the tenancy agreement. The additional charge to the monthly rent is £15 per pet per calendar month up to a maximum of £30 per calendar month.

Council Tax Band:

C

Agents Notes:

All measurements have been taken using electronic measuring devices and are only approximate.

Energy Efficiency Rating		
	Current	Potential
Very energy efficient - lower running costs		
(92+) A		89
(81-91) B		
(69-80) C		
(55-68) D	67	
(39-54) E		
(21-38) F		
(1-20) G		
Not energy efficient - higher running costs		
England, Scotland & Wales		EU Directive 2002/91/EC

